

## ReSound Non-Rechargeable BTE and RIC Devices: Changing the Battery



1

Remove a new battery from the pack.



2

Remove the sticker from the top of the battery.



3

Let the battery sit for approximately 1-2 minutes.



4

Pull the battery door down on your device to open.



5

Open the battery door all the way.



6

Place the battery into the door facing up.



7

Close the battery door.



8

The battery has been changed successfully.

## ReSound Non-Rechargeable BTE and RIC Devices: Changing the Battery

 **WARNING:** If the batteries are not inserted correctly, the device will not work and the batteries may build up heat. If this happens, please remove the batteries.

 **NOTE:** Always use new Zinc-Air batteries that have a minimum remaining shelf life of at least one year.

How to  
insert the  
battery in  
your hearing  
aid

1

Open the battery door completely by using your fingernail. Remove the used battery if present.

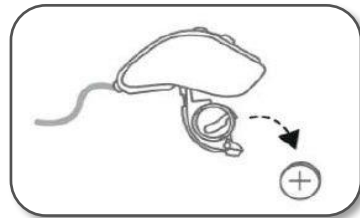

2

Prepare the new battery. Remove the protective foil to activate the battery. Wait for two minutes before inserting the battery into the hearing aid.

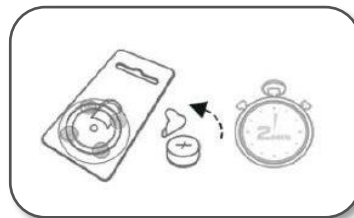

3

Insert the new battery with the positive side in the correct position. Always insert the battery in the compartment door, never directly into the hearing aid. Close the battery door.

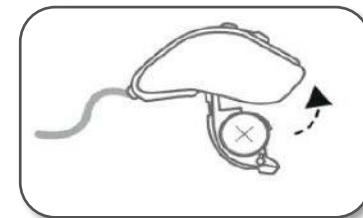

**ReSound Government Services**  
8001 E. Bloomington Freeway  
Bloomington, MN 55420  
USA  
[gs.resound.com](http://gs.resound.com)

**ReSound GN**