

## Signia App Set-up Instructions for Wireless Hearing Aids: iPhone

FOR MORE INFORMATION: see the interactive user guide:

<https://www.signia-hearing.com/signia-app/>

For assistance with pairing and using the Signia app, please call the **Consumer Hotline: 800-350-6093**

**Step 1:** Download the Signia app from the App store. It is compatible with iOS version 9.3 and higher.

**Step 2:** Turn on Bluetooth on your phone and pair your Signia hearing aids following these instructions:



Select the option  
"Accessibility" under "Settings".

Select the option "Hearing Aids"  
under "Accessibility".

You will get a pairing request in a pop-up  
window where you have to tap "Pair".  
Please note that you will get a separate  
pairing request for each hearing aid e.g.  
if you have 2 hearing aids, then you will  
get 2 pairing requests.

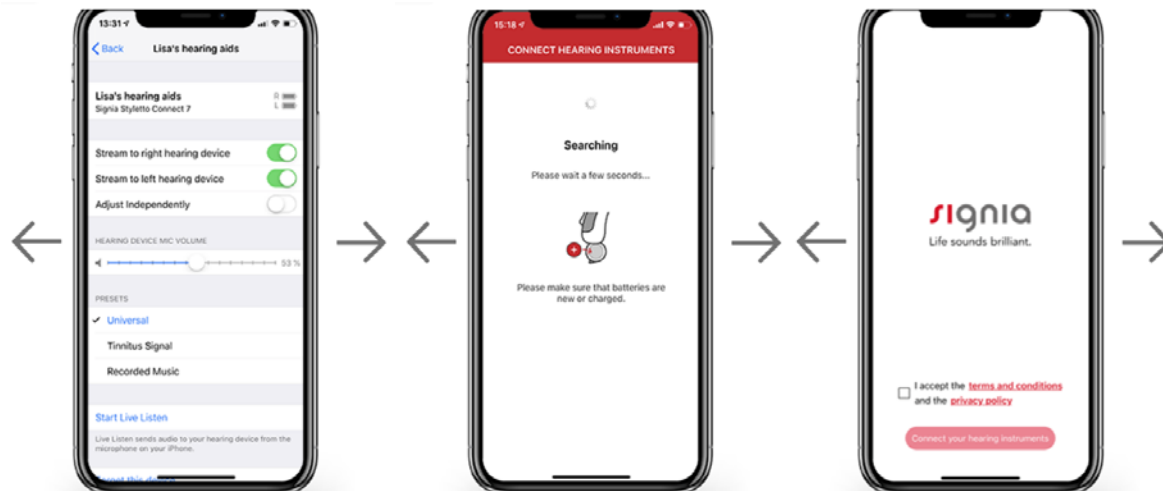

As soon as the pairing has been successful, you will see the basic settings that you can manage via your Apple device (microphone volumes, presets, etc.).

Return to the Signia app and the app will automatically search, find and connect to your hearing aids.

Accept the terms and conditions.

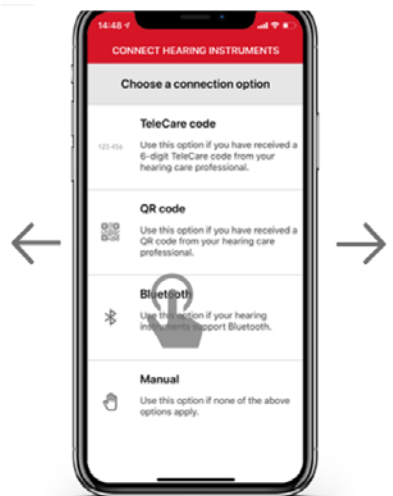

In the main menu, you will find different connection options to choose. Select the option "Bluetooth" if you have Bluetooth hearing aids.

The connection will be established successfully. You can start using the app by tapping on "Let's Go".